

FLOOR TO WALL INJECTION - NON-FLOATING SLAB

1. ANGLE DRILL THROUGH CONCRETE TOWARDS THE JOINT, ½ INCH DIAMETER HOLES THROUGH THE CONCRETE SLAB. HOLES SHOULD BE A MAXIMUM OF 6 INCHES OFF THE JOINT, MIDPOINT INTERSECTION DESIRED.
2. SPACE DRILL HOLES A MAXIMUM OF 12 INCHES APART. SPACING WILL VARY DEPENDING ON THE WIDTH (TIGHTNESS) OF THE JOINT.
3. INSERT ½ INCH PACKERS.
4. PUMP POTABLE WATER INTO EACH PORT TO ENSURE MOISTURE FOR REACTIVITY WITH GROUT.
PUMP ADCOS PURINJECT® 1C FLEX UNDER MODERATE PRESSURE AS REQUIRED, TAKING INTO CONSIDERATION THE EXPANSION FACTOR OF 20 TIMES FOR ADCOS PURINJECT® 1C FLEX.
5. WATCH FOR PORT TO PORT TRAVEL TO ENSURE COVERAGE.
6. REMOVE PORTS AND REPAIR DRILL HOLE USING RAPID SET MORTAR.

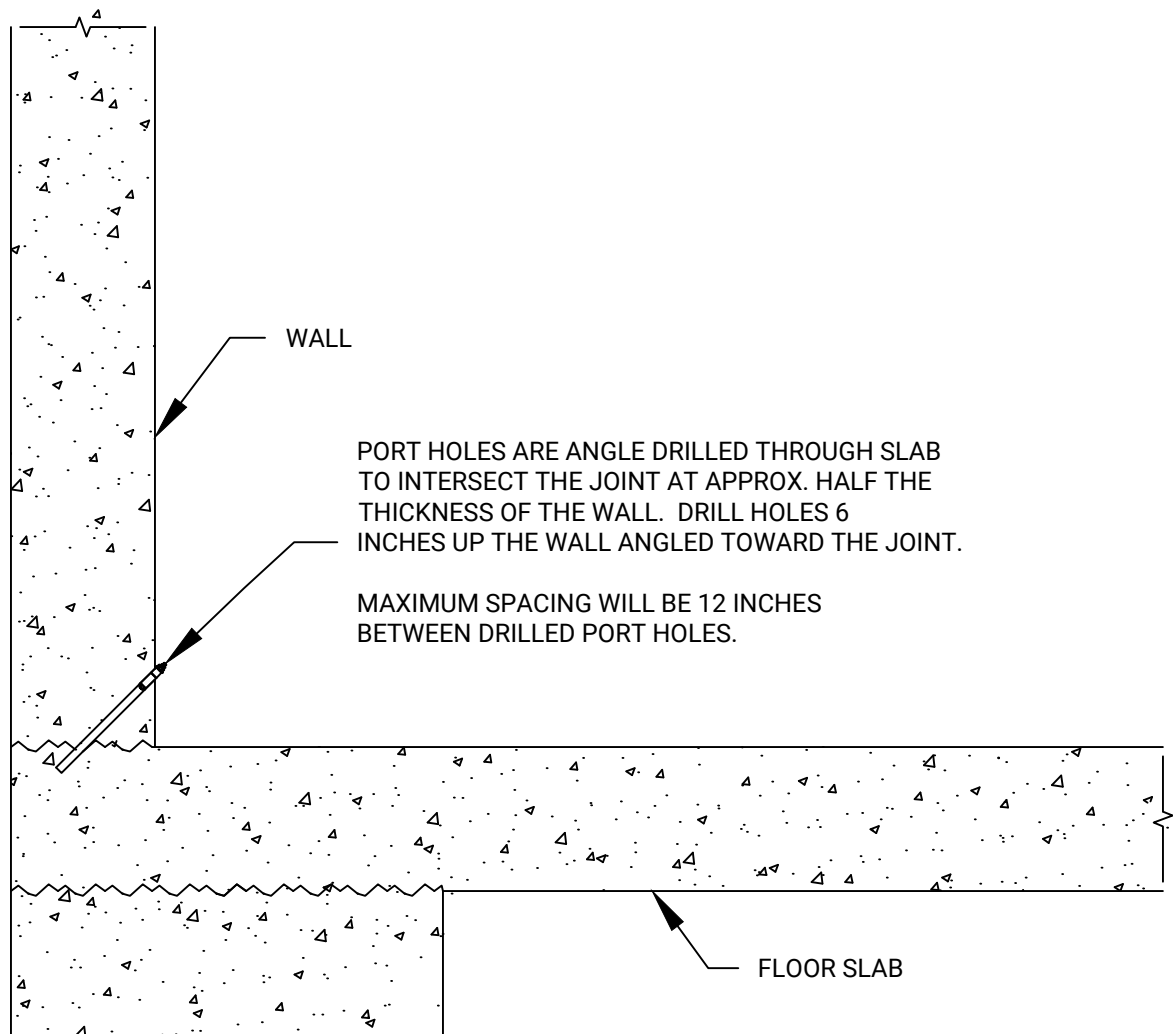

FOUNDATION SECTIONAL VIEW
AS NOTED

DATE
10/30/2023

DRAWN_BY
D.J.I.

SCALE
N.T.S.

PRODUCT_NUMBER
PURINJECT® 1C FLEX

DRAWING_TITLE

**FLOOR TO WALL INJECTION - NON-FLOATING
SLAB**

ADCOS